

Bosch 24" Compact Laundry

— Design on 500 and 800 Series —

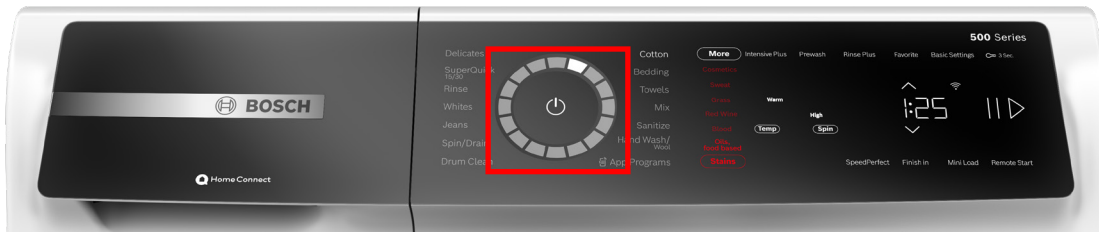

Bosch laundry units offer a **Premium LED Touchscreen** on both washers and dryers. Just run your finger around the rim of the dial **(in red box above)** to access all cycles.

- **Washer Capacity** at 2.4 cu. ft (the equivalent of holding 12 full sized bath towels)
- **Black Doors with Chrome Ring Accents** allow for a more luxurious aesthetic look. Both series dryer doors are **Field Reversible**.
- An **Internal LED Light** is activated when unit doors are open to get a better viewing experience



Innovations with Major Results

4D Wash System

- Allows clothes to be targeted further with the addition of an extra pump and nozzle
- Each washer will pump water back into the units and spray soapy water to ensure every item gets a full clean.
- Found on **Both** the 500 and 800 Series

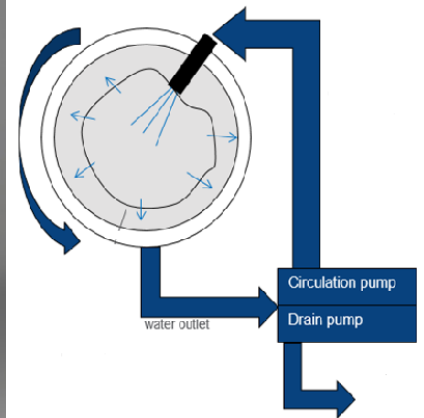

i-Dos™ System*



- Automatically dispenses the perfect amount of detergent for each load (on auto cycle only)
- Different sensors measure for soil, water and textile levels.
- Chamber 1 holds 32 oz/Chamber 2 holds 16 oz
- Manual chamber (far left) can be used if consumer would like to bypass this feature

*800 Series Washer Only

Steam Restore*

- Reduces wrinkles and minimizing overall ironing
- Once container is filled**, dryer sensor sprays a cool, yet fine mist into the drum. Creates a natural steam and helps smooths fabric

*800 Series Dryer Only

**Fill the chamber with cool water up to 6 oz. with the included reservoir

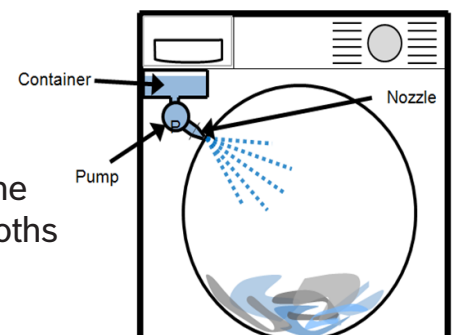

- Remote Monitoring: Check status and get notifications when a cycle is complete
- Easy Start: Add the type of clothing to the basket and get a recommendation for wash cycles/options
- Smart Dry: Automatically selects the best dry cycle based on the last wash

Heat Pump Drying (500 and 800 Series)

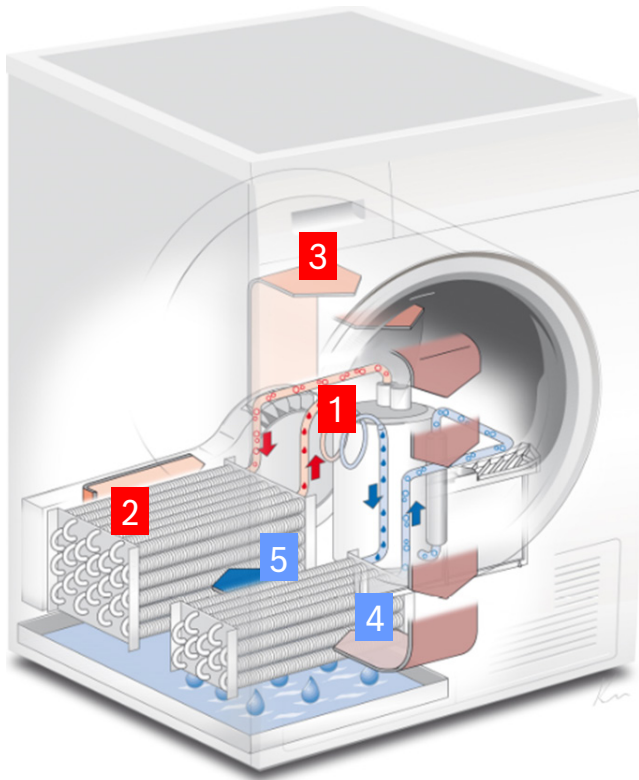

1. **COMPRESSOR** pressurizes the gas, heating it up
2. **HEAT EXCHANGER** heats the air as the super heated gas passes through it's coils
3. Heated air enters the drum to dry clothing
4. **CONDENSER** cools the moist air, extracting the water
5. Cooled air is recycled back through the heat exchanger to continue the drying process

Self Cleaning Condenser™

Condensation and Heat Pump dryers need to have their condenser cleaned regularly to remove lint therefore maintaining its efficiency. The Bosch Heat Pump dryer has **patented** self-cleaning technology to ensure consistent dry times and energy efficiency!

How It Works:

- Water collected in the drying process is pumped to a tank and stored
- Multiple times each cycle the water is released to shower the condenser
- Water (and lint) leaves the dryer via the drain standpipe

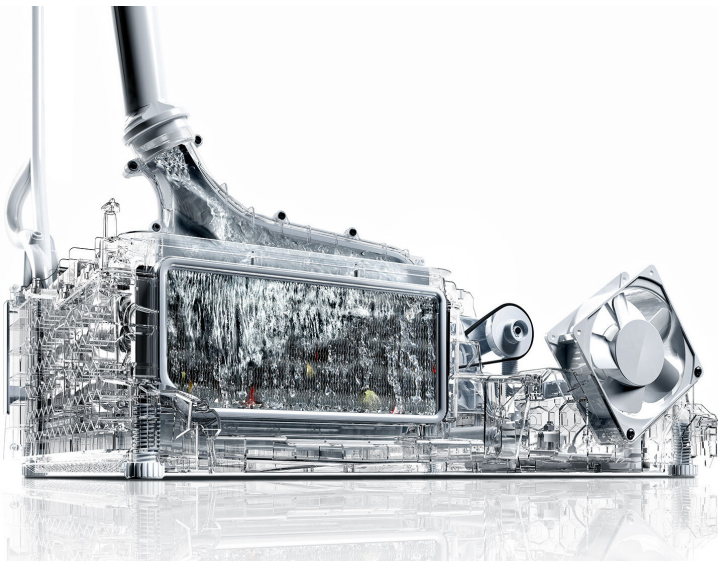

Condensation Drying (300 Series)

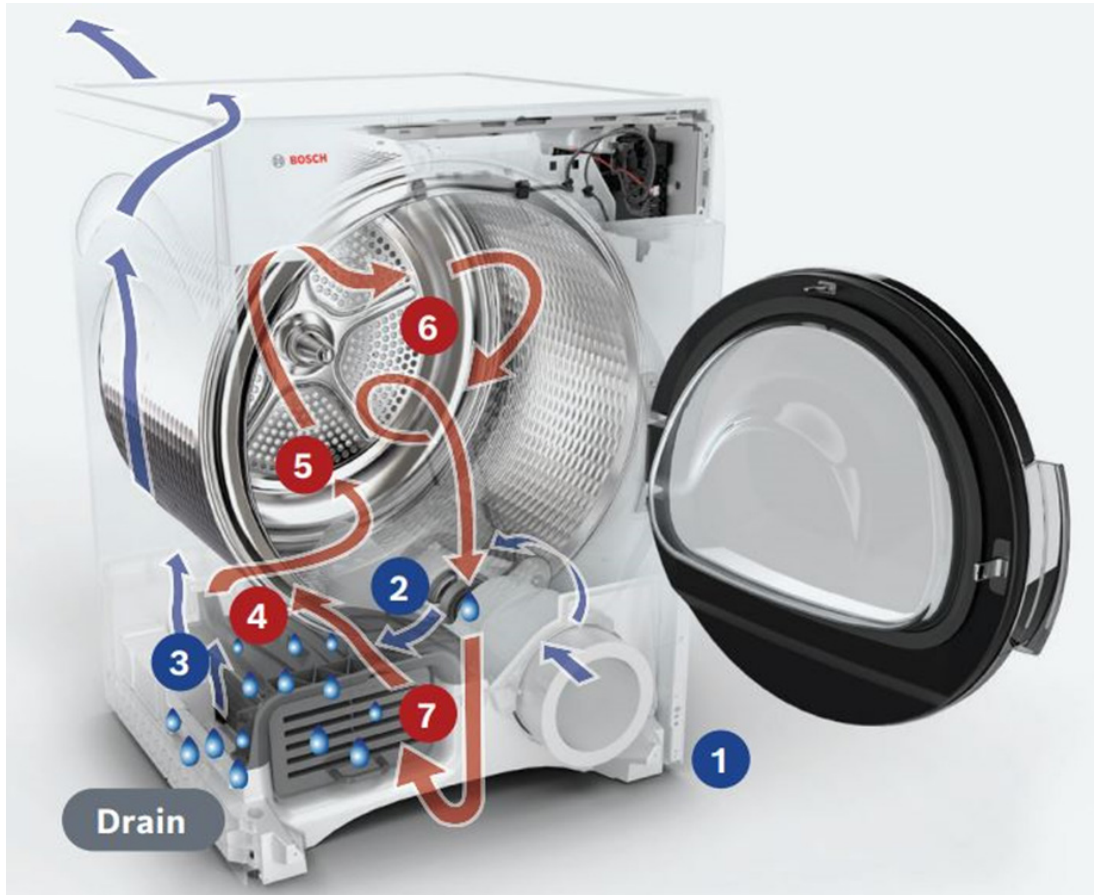

1. Ambient air (cool) enters dryer
2. Ambient air enters condenser
3. Ambient air (warm and dry) exits condenser and exhausted
4. Process air (dry) exits condenser. A fan blows it into heater
5. Process air enters heater (heating element) and is heated
6. Process (heated) air enters drum to absorb moisture and dry laundry
7. Process air (warm, wet) enters condenser and is cooled, releasing the moisture.

Drain: Condensed water is collected and pumped to drain

Heat Pump vs. Condensate

Summary of Differences

| | Heat Pump | Condensate |
|----------------------------|-----------------------------|--------------|
| Heating Element | No | Yes |
| Clean the Condenser | No* | Yes |
| Cycle Time | Takes slightly Longer | --- |
| Efficiency | Energy Star® Most Efficient | Energy Star® |
| Cost | \$\$\$ | \$\$ |

*Bosch's patented SelfCleaning Condenser™ eliminates the need to manually clean the condenser while other heat pump dryers require it



Differences Explained

Heating Element

Heat Pump: No - Closed-loop heat exchange system

Condensate: Yes - 2,520 watt element

Clean the Condenser

Heat Pump: Self-cleaning condenser – no maintenance

Condensate: Yes – remove and rinse condenser periodically

Cycle Time

Heat Pump: A few minutes longer than condensate, due to cleaning the condenser

Condensate: Slightly longer than 24" vented dryer with identical load (3-10 minutes*)

*According to CAN/CSA-C361-92 and IEC61121:2005 tests

Efficiency

Heat Pump: Energy Star® Most Efficient 2026 – uses 60% less energy than conventional dryers

Condensate: Energy Star®

Cost

Heat Pump: Increased upfront purchase cost – significant savings on energy usage for the life of the unit

Condensate: Technology is slightly less expensive

Leak Protection & Installation



AquaShield® Hoses

- Included with **500 & 800 Series** washing machines
- The “hose within a hose” contains a valve on the end so if there is ever a water leak, it will stop the water flow and contain the leak
- **If more room is needed for plumbing box clearance**, order (2) Part Number #00645787. It is a 6” stainless steel hose extension

AquaStop® Plus

- Leak protection built into the **500 & 800 Series** washing machines
- The base of the washer contains sensors that, if triggered by a leak, will close the water inlet and activate the drain pump

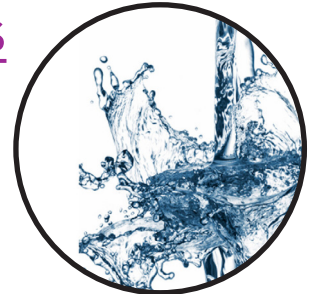

Electrical Hookup – One Plug Solution

Installation requires a single
240V NEMA 14-30R (30 Amp) Receptacle



Front of adapter

- **EVERY DRYER** ships with a power adapter
- Each washer & dryer have their own 15 Amp power cords (240V NEMA 6-15 plug)
- Plug **both** washer & dryer cords into adapter
- Plug BSH Adapter into **NEMA 14-30R** receptacle



Back of adapter

Plug adapter into
30 Amp receptacle

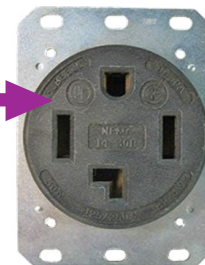

For a 240V **NEMA 10-30R** receptacle (3 prong),
sell the 3 Prong Power Adapter accessory **WTZPA30US**

Configurations and Accessories



- All 300, 500 and 800 Series units can be stacked, installed side-by-side or placed on pedestals
- Please note pedestals are **Unit Specific**
- 500 and 800 series dryer doors are **Field Reversible**

..... Pedestal and Stacking Kit Accessories



WMZPW4XW
Washer Pedestal
800 Series



WTZPW4XD
Dryer Pedestal
800 Series



WMZPW40W
Washer Pedestal
300 and 500 Series



WTZPW40D
Dryer Pedestal
300 and 500 Series

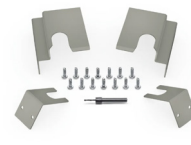

WTZSB3XUC
Stacking Kit
with Brackets
for 800 Series



WTZSB30UC
Stacking Kit
with Brackets
for 300 and 500
Series



WTZ2750XUC
Stacking Kit **WITH**
Shelf 800 Series



WTZ2751XUC
Stacking Kit
WITHOUT Shelf
800 Series



WTZ27500UC
Stacking Kit
WITH Shelf
500 Series



WTZ27510UC
Stacking Kit
WITHOUT Shelf
500 Series



WTZ11400UC
Stacking Kit
WITH Shelf
300 Series



WTZ20410UC
Stacking Kit
WITHOUT Shelf
300 Series



WTZPA20UC
4-Prong Power Adapter
(Included with **ALL** Dryers)



WTZPA30US
3-Prong Power Adapter
(Sold Separately)



WMZ20600
Drying Rack
(Works on **ALL** Dryers)



Part Number 00645787
AquaShield® Hose Extension
(If Needed for Plumbing Box Clearance)

Bosch dryers are supplied with WTZPA20UC adapter to fit a standard 4-Prong, 30A, dryer receptacle (NEMA 14-30R) to power both Bosch washers and dryers. 3-Prong Adapters may be ordered directly from Bosch (not supplied with washer or dryer). Use of 2 individual NEMA 6-15R or 6-20R receptacles/circuits may be used as alternative means to power washer and dryer.

Compact Washers

300 Series
WGA14400UC

500 Series
WGB24600UC

800 Series
WGB246AXUC



- 2.2 cu ft capacity
- 1400 RPM spin speed
- EcoSilence BLDC Motor
- 52 dBA - washing
- 72 dBA - spinning
- SpeedPerfect® Cycle
- AntiVibration System
- 15 Programs and 6 Options



- + 2.4 cu ft capacity
- + 1600 RPM spin speed
- + 51 dBA - washing
 - 75 dBA - spinning
- + AquaStop® Plus Leak Protection
- + Interior LED drum light
- + Premium LED touch controls
- + Home Connect®
- + 14 Programs and 10 Options



- + i-DOS™ automatic dosing
- + Pearl Steel Finish
(White Not Available on 800 Series)

Compact Dryers

300 Series
WPA1210UC

500 Series
WQB245B0UC

800 Series
WQB245AXUC



- 4.0 cu ft capacity
- 67 dBA
- 15 Programs and 6 Options
- AntiVibrations System
- Stainless Steel Drum
- Condensation Drying



- + 62 dBA
- + 14 Programs and 8 Options
- + Reversible Door
- + Premium LED controls
- + Interior drum LED light
- + Home Connect®
- + Patented SelfCleaning Condensor™
- + Heat Pump Drying



- + Steam Restore
- + Pearl Steel Finish
(White Not Available on 800 Series)

