



# This Month: **New** Bosch Downdraft Hoods!



HDD80050UC 30" Downdraft  
HDD86050UC 36" Downdraft



\*Rendering of 36" Downdraft with NGM Cooktop

### Key Features:

- 3 Speeds
- Blower Sold Separately ( Required)
- 600 CFM Flexible Integral, Inline and Remote Blower Options for Personalization and Flexibility
- Sleek New Filter Panel Design Conceals Dishwasher Safe Aluminum Mesh Filters and Acts as Splatter Guard
- 5 Possible Discharge Connections to Fit Your Kitchen Design
- Downdraft Automatically Shuts Off When Retracted
- Installation Accessories Sold Separately (Transitions Front Rough In Plate, Gas Cooktop Seal Kit)
- Recirculation Possible, Sold Separately

## New Blower Installation Possibilities\*

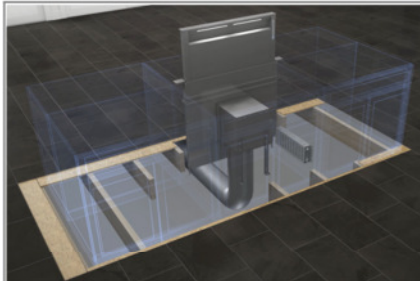

### FRONT EXHAUST

- Front downward application shown
- Integral blower can rotate for left or right exhaust

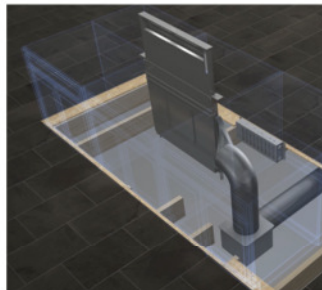

### BELOW FLOORLINE\*

- Flexible blower can be placed below the floor line to discharge at left, right, front, or rear sides

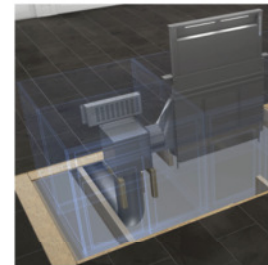

### SIDE EXHAUST\*

- Left or right side exhaust options to preserve precious kitchen storage space or if ducting is more convenient for these configurations

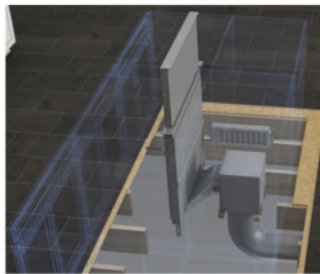

### REAR EXHAUST\*

- Rear exhaust options to preserve precious kitchen storage space or if ducting is more convenient for this configuration.
- Ability to install below floor line as inline blower application

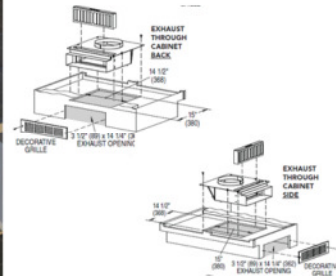
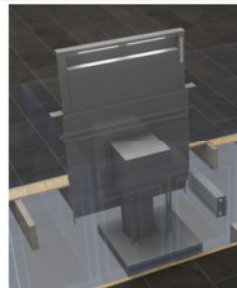

### RECIRCULATION

- Allows for non-ducted downdraft installation
- Recirculation module and metal grill vent plate placement can be rotated for flexible exhaust placement

\*Note: Some Applications may require deeper cabinets. Side and rear exhaust require at least 18" of clearance to fit the blower and/or ductwork. Refer to Installation Instructions.



# This Month: **New** Bosch Downdraft Hoods!

## Accessories\* Overview (Sold Separately)

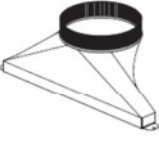
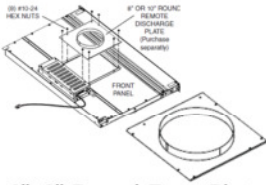
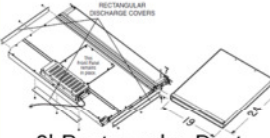
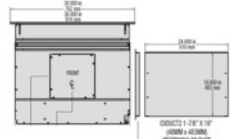
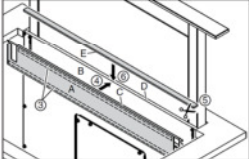
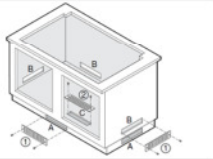
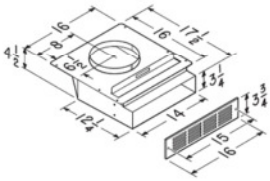
REMOTE AND INLINE BLOWER APPLICATION TRANSITIONS / DUCTING ACCESSORIES			
 <p><b>6", 8" Side/Rear Transition</b></p> <ul style="list-style-type: none"> <li>Flexible Transition Design Allows For Left, Right Or Rear Venting</li> </ul>	 <p><b>6", 8" Round Front Plate</b></p> <ul style="list-style-type: none"> <li>For Inline And Remote Blower Downdraft Applications With Front Downward Venting</li> </ul>	 <p><b>2' Rectangular Duct</b></p> <ul style="list-style-type: none"> <li>Can Be Used As An Extension To Exhaust Through A Cabinet Or Wall</li> <li>Needs Transition To Connect To Downdraft Housing At Sides Or Bottom</li> </ul>	 <p><b>2' Rectangular Duct Transition</b></p> <ul style="list-style-type: none"> <li>Transition To Connect 2' Rectangular Duct To Downdraft</li> </ul>
OTHER OPTIONAL ACCESSORIES			
 <p><b>30", 36" Gas Cooktop Seal Kit</b></p> <ul style="list-style-type: none"> <li>Required for installation with Gas cooktops</li> <li>Includes trim, seal, metal grille, and fasteners</li> </ul>		 <p><b>Recirculation Kit</b></p> <ul style="list-style-type: none"> <li>Allows for non-ducted downdraft installation by eliminating the need to exhaust to the exterior of the home*</li> <li>Charcoal Filter replacement available</li> </ul>	

\*Accessory May Be Required For Installation. See Manual

\*Note: Some Applications may require deeper cabinets. Side and rear exhaust require at least 18" of clearance to fit the blower and/or ductwork. Refer to installation instructions.

## Required Accessories Overview Blowers\* (Sold Separately)

▶ **DHG602DUC FLEXIBLE INTEGRAL BLOWER**

- ▶ Capable Up To 600 CFM In Performance
- ▶ Can Be Rotated To Exhaust Downward Or Towards Side
- ▶ Can Be Mounted Directly To Downdraft Or As An Inline Blower
- ▶ Integral Installation Is Best Option For Performance & Efficiency
- ▶ Non-Ducted Recirculation Possible With Separate Accessory Kit

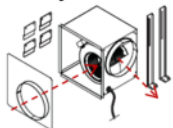

**NEW**

▶ **DHG6105NUC INLINE BLOWER**

- ▶ Capable Up To 600 CFM In Performance
- ▶ Installed 'Inline' With Your Ducting, Somewhere Between The Downdraft And Exterior, Such As Your Attic Or Crawl Space
- ▶ Inline Blowers Have The Relative Quietness Of A Remote Blower Without Being Visible Outside Your House. Better Performance Than Remote, But Not As Efficient As Integral Blowers



**CURRENT**

▶ **DHG6023RUC REMOTE BLOWER**

- ▶ Capable Up To 600 CFM In Performance
- ▶ Installed 'Remotely' And Separate From The Downdraft On A Rooftop Or A Wall
- ▶ An Option To Keep The Noise Level Down In The Kitchen Because The Blower Is Located Outside The Home



**CURRENT**

\*Additional Accessories Required For Installation, See Manual



## This Month: Resources



**BOSCH**

Invented for life



- **www.AskBoschBestBuy.com**
  - Chat with a knowledgeable representative
  - Get answers to all of your Bosch appliance questions
  - Obtain product information, inspiration and selling tools
  - Gain knowledge of the most current products
  - View Best Buy / Bosch current promotions
  - Order missing parts for displays
  - Mobile device optimized
- **BestBuy.com/Bosch**
  - Brand page on BestBuy.com
- **Text for Specs**
  - Text any Bosch model number to 21432 and receive product specifications back in just seconds!
- **Contact**
  - Customer Service - 800-944-2904

